

Fluoropolymer Flexible Joint Bellows Type **FLONEX α T-3**

3-arch thick design fluoropolymer bellows that are excellent in high temperature and vacuum resistance.



Specified by
Ministry of Land,
Infrastructure,
Transport and
Tourism

Make-to-
order
products

Feature

Thick bellows

Bellows are thick design and excellent in high temperature and vacuum resistance.

Clean = Pure

Virgin fluoropolymer material is free of any impurities or soluble substance such as stabilizers, antioxidants or carbon. It is considered as one of the most hygienic material.

Compact Design

A short face to face dimension enable compact design of the pipe.

Operating Conditions and Performance

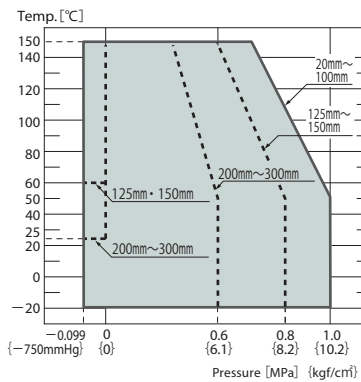

- Use after confirmation that maximum operation pressure and maximum service temperature is within the operation range.

Structure

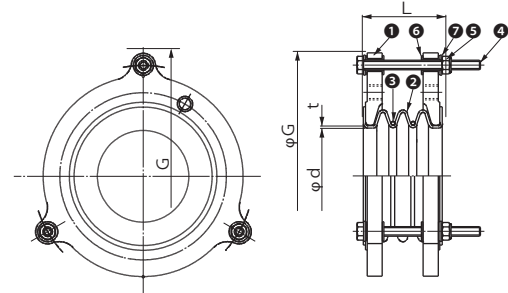

No.	Parts	Material	No.	Parts	Material
①	Flange	FCD	⑤	U nut	SS400
②	Bellows	Fluorine resin	⑥	Rubber bushing	CR
③	Reinforcing Ring	SUS304	⑦	Plain washer	SS400
④	Stop bolt	SS400			

Flange compatible dimension	Standard	JIS10K	Different from above figure	
	changeable	○		JIS5K
○		PN10		
○		PN16		
○		JIS20K		
○		ANSI		
Material	Standard	FCD	Different from above figure	
	changeable	○		SS400
		○		SUS304
		○		SUS316
×	Polyvinyl chloride			

Dimensions and Allowable Movements

Nominal Dia.		Dimension [mm]				Mass [Kg]	Allowable Movement [mm]				Installation Tolerances [mm]			
mm	inch	L	φd	t	G		Eccentricity	Elongation	Compression	Deflection angle	Eccentricity	Elongation	Compression	Deflection angle
20	3/4	50	23	2.5	141.2	1.8	5	10	10	8°	2	2	2	2°
25	1	50	23	2.5	166.2	2.0	5	10	10	8°	2	2	2	2°
32	1 1/4	50	30	2.5	176.2	2.3	5	10	5	8°	2	2	2	2°
40	1 1/2	55	36	2.5	181.2	2.4	5	10	10	8°	2	2	2	2°
50	2	70	46	3.0	202.6	3.2	8	15	15	8°	3	2	2	2°
65	2 1/2	80	60	3.0	229.0	4.5	5	10	10	8°	2	2	2	2°
80	3	100	72	3.3	242.2	4.9	8	25	20	8°	3	5	3	2°
100	4	100	93	3.5	257.6	6.6	12	25	20	8°	5	5	3	2°
125	5	100	114	3.5	319.9	11.0	12	25	15	8°	5	5	2	2°
150	6	100	140	3.5	349.9	13.0	12	25	10	8°	5	5	2	2°
200	8	160	190	4.0	393.6	19.0	14	30	30	8°	6	6	6	2°
250	10	160	235	4.0	463.8	26.0	14	30	30	8°	6	6	6	2°
300	12	160	283	5.0	528.0	31.0	14	30	30	8°	6	6	6	2°

- Mass is the data when material is FCD, and flange is JIS10K flange.
- Use a joint within the range of allowable displacement.
- Fixing allowable dimension is included in allowable displacement.
(allowable displacement = fixing time displacement + operation displacement)
- Each displacement in chart are data of single displacement, so for multiple displacements, correction is necessary.
For correction method, refer to "Attention for handling or "TOZEN HP".
- Referring to "fixing bolt dimension table", and use fixing bolt. Nut is not necessary.
(When companion flange is JIS 10K, material is SS400, and when plain washer and gasket are not used.)

This brochure may be revised without prior notice. We apologize in advance for any inconvenience this may cause.

Agent

TOZEN Corporation
8-4, Asahi, Yoshikawa
Saitama 342-0008 Japan

